

# Loggia Bay



## Loggia Bay

Impressive volume



Model shown with the metal and fabric guard rail option

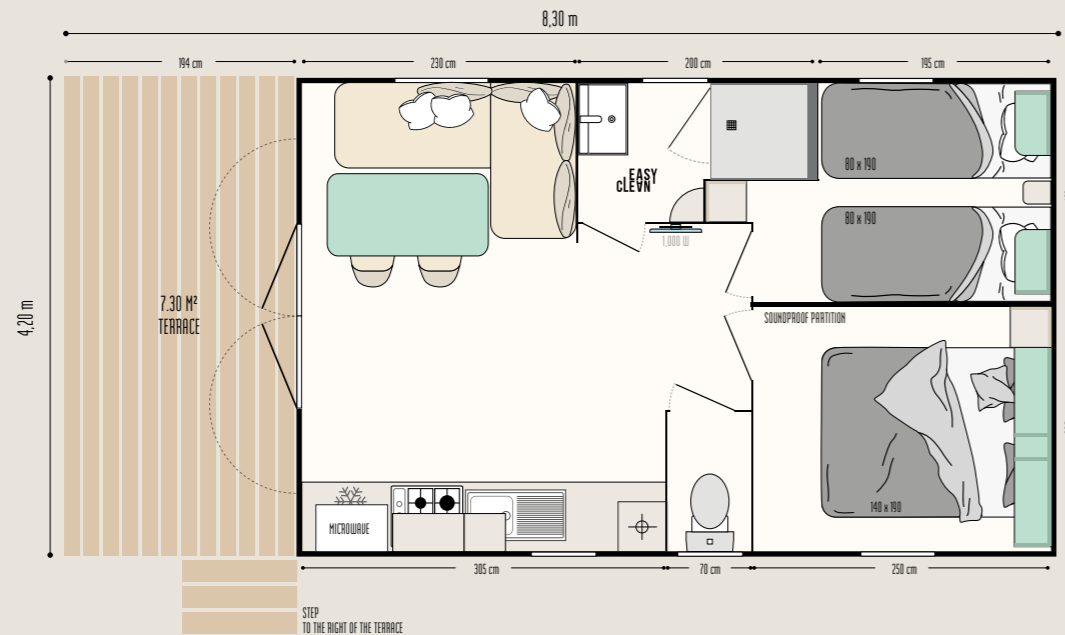

### THE HIGHLIGHTS

- + Large living room with a width of 4.20 m
- + Soundproof partition between the two bedrooms
- + Step positioned as desired: on the left or right of the terrace

### The TOP options

Sliding doors instead of a double entrance door or fixed windows on each side of the entrance door.  
Combination blackout blind and mosquito screen.  
500 W convector heater in the bedrooms and the bathroom.

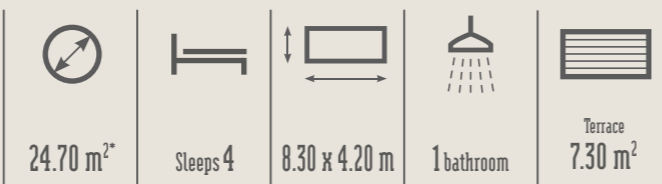

### New MODUL'HOMES: the features, the layouts - you choose!



Separate room



Relaxation area



Bike rack and/or storage

An entrance hall, relaxation area or storage space, modul' homes are perfectly suited to mobile homes with 1- and 2-slope roofs. They can be placed at the gable end or separately from the mobile home.

### The model that offers real roominess

#### KITCHEN

- Microwave cabinet
- Deep pan drawers
- White 4-ring gas hob
- 115 L tabletop refrigerator
- Roller blind

#### LIVING ROOM

- Dining table with round-edged top and angled metal legs
- Corner sofa
- 2 black inside/outside chairs
- Roller blind

#### MASTER BEDROOM

- Open storage cabinet above the headboard with integrated wardrobe
- Headboard fitted with adjustable reading lights with built-in switch
- 2 bedside tables
- 18-slat bed base with raised legs and 35 kg/m³ high-resistance foam mattress
- Blackout curtain

### STANDARD EQUIPMENT

- Smoke detector with 10-year warranty
- 100% LED lighting
- 1,000 W convector heater
- 35 kg/m³ high-resistance, OEKO-TEX-certified foam mattress
- High and low vents
- Phthalate-free linoleum
- Central circuit breaker
- Aerial socket and TV cabling
- Large capacity kitchen wall units
- Kitchen base units on feet with PVC plinths
- Flow reducers on sink and washbasin mixer taps (7 l/min)
- Top-of-the-range, ACS-certified mixer taps
- Hydropower natural-draught gas water heater
- Environmental awareness sticker



#### CHILDREN'S/GUEST BEDROOM

- Open storage above the headboard
- Bedside table
- Wall-mounted storage unit at the foot of the bed
- 18-slat bed base with raised legs and 35 kg/m³ high-resistance foam mattress
- Blackout curtain

#### BATHROOM & TOILET

- Easy Clean bathroom - easy to clean and designed to last.
- 80 x 80 cm soft-touch shower tray with extra-flat threshold and high door with safety glass
- Frosted window for greater privacy
- Wall-mounted vanity unit with built-in towel rail
- Storage shelves
- Dual flush toilet (3/6 litres) and reinforced soundproofing

# 2 BEDROOMS