

# Super Mercure Riviera

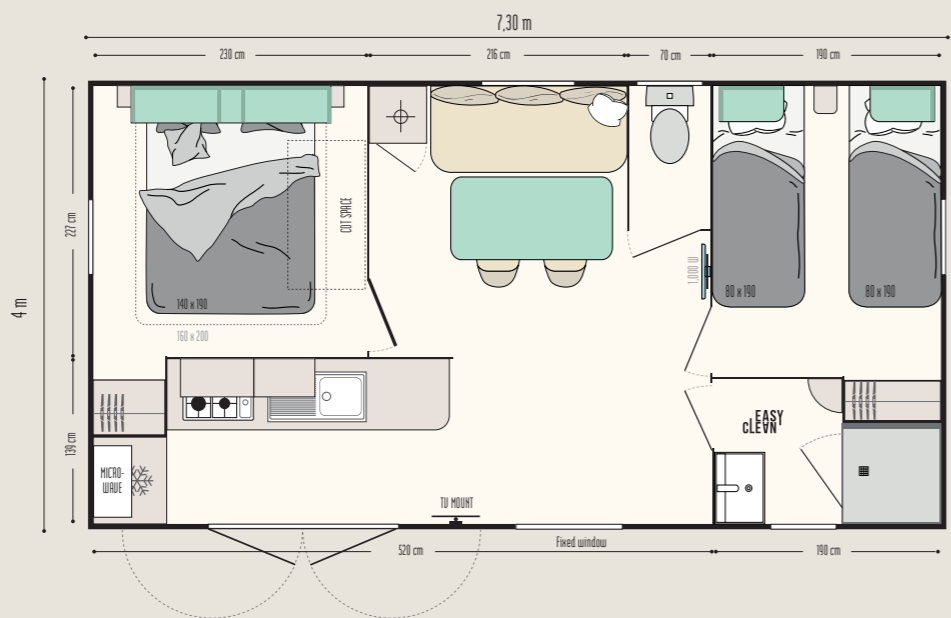

## Super Mercure Riviera

An inviting kitchen in a compact space



### THE HIGHLIGHTS

- + The advantages of the Super Mercure and its optimised family spaces
- + The Riviera design and its large L-shaped kitchen opening onto the terrace
- + Wide 87 cm fixed window on the living room side can be an opening window as an option

### The TOP options

- Heated towel rail in the bathroom.
- High transverse bed for more space or more beds in the children's bedroom.
- Door in place of the fixed window.

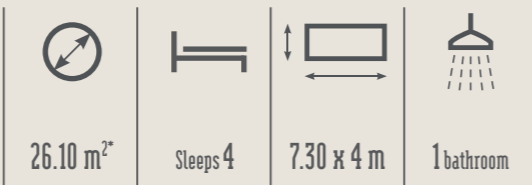

### New MODUL'HOMES: the features, the layouts – you choose!

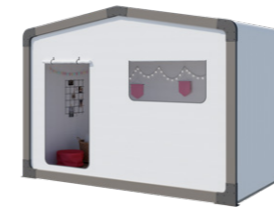

Separate room



Relaxation area



Bike rack and/or storage

An entrance hall, relaxation area or storage space, modul'homes are perfectly suited to mobile homes with 1- and 2-slope roofs. They can be placed at the gable end, as an entrance, or separately from the mobile home.

### STANDARD EQUIPMENT

- Smoke detector with 10-year warranty
- 100% LED lighting
- 1,000 W convector heater
- 35 kg/m<sup>3</sup> high-resistance, OEKO-TEX-certified foam mattress
- High and low vents
- Phthalate-free linoleum
- Central circuit breaker
- Aerial socket and TV cabling
- Large capacity kitchen wall units
- Kitchen base units on feet with PVC plinths
- Flow reducers on sink and washbasin mixer taps (7 l/min)
- Top-of-the-range, ACS-certified mixer taps
- Hydropower natural-draught gas water heater
- Environmental awareness sticker



### The inviting model

#### KITCHEN

- Microwave cabinet
- Deep pan drawers
- White 4-ring gas hob
- 115 L table-top refrigerator

#### LIVING ROOM

- Dining table with round-edged top and angled metal legs
- Sofa with feet
- 2 black inside/outside chairs
- TV mount
- Roller blind

#### MASTER BEDROOM WITH SPACE FOR A COT

- Open storage cabinet above the headboard
- Headboard fitted with adjustable reading lights with built-in switch
- 2 bedside tables
- Hotel-style wardrobe with drawer at the foot of the bed
- 18-slat bed base with raised legs and 35 kg/m<sup>3</sup> high-resistance foam mattress
- Blackout curtain

#### CHILDREN'S/GUEST BEDROOM

- Open storage above the headboard
- Bedside table
- Hotel-style wardrobe with drawer at the foot of the bed
- 18-slat bed base with raised legs and 35 kg/m<sup>3</sup> high-resistance foam mattress
- Blackout curtain

#### BATHROOM & TOILET

- Easy Clean bathroom - easy to clean and designed to last.
- 80 x 80 cm soft-touch shower tray with extra-flat threshold and high door with safety glass
- Frosted window for greater privacy
- Wall-mounted vanity unit with built-in towel rail
- Storage shelves
- Dual flush toilet (3/6 litres) and reinforced soundproofing

2 BEDROOMS